

TL3 Accent Light



Low Volt - Precise Beam Pattern

The Bronzelite TL3 Series Accent luminaires are designed to produce precise beam patterns utilizing T3, MR8 or MR11 lamps. The rugged and durable housing and shroud are die cast aluminum with a variety of powder coat finishes. The 12 volt mounting arm is used with a low voltage transformer for open settings and terrains to enhance and beautify architectural building materials and landscape. The 120/12 volt mounting arm eliminates the need for a low voltage transformer on those harder to reach mounting areas. Mounting accessories for ingrade junction boxes, surface mount, wall mount, or tree mount applications complete the task and get the expected lighting results.

Specifications

Housing:

Die cast aluminum (copper free) with stainless steel fasteners and fully adjustable swivel arm with vibration-proof locking teeth. Choice of shrouds, specify shield for glare control.

Lens:

Tempered glass, part of shroud.

Lamps:

35 watt maximum MR11, 20 watt maximum T3, or 27 watt maximum 1156 low voltage lamp halogen, not included.

Gasket:

High temperature silicone.

Sockets:

MR8, MR11, T3: High-temperature porcelain bi-pin. 1156 single contact bayonet (S-8).

Wiring:

Low voltage prewired with a 3' pigtail and a quick connector for easy hook-up to the low voltage supply cable (not supplied). 12 volt system requires remote transformer (sold separately). The 120/12 transformer are prewired with high temperature #18 AWG.

Electrical:

TL3035MR11 or 20T3 - stepdown transformer reduces 120V line voltage to 12 volts. Transformer is potted/ encapsulated and features thermal overload protection.

Warranty:

Three year limited warranty.

Certification:

UL Listed to U.S. and Canadian safety standards for wet locations.

IP66:

Dust-tight and sealed against direct jets of water.

Accessories:

(Must Be Ordered Separately and Field Installed)

ML7:

Honeycomb louver.

LVTS3:

Stepdown transformer for use with low voltage fixtures, Primary: 120VAC, 60 Hz., Secondary: 11/12/13 VAC., Load: 300VA.

LVTS6:

Stepdown transformer for use with low voltage fixtures, Primary: 120VAC, 60 Hz., Secondary: 11/12/13 VAC., Load: 600VA.

LVTS9:

Stepdown transformer for use with low voltage fixtures, Primary: 120VAC, 60 Hz., Secondary: 11/12/13 VAC., Load: 900VA.

TL3 Accent Light

Project:

Fixture Type:

N=No reflector or MR Lamp
 E=Extender
 BLK=Black
 DB=Dark Bronze
 VRD=Verde

Ordering Logic

Wattage/Lamp	Model No.	Shroud	Distribution	Finish
20W T3*	TL3020	E	N	()
35W MR11*	TL3035LV	E	N	()
20W T3 (integral transformer)	TL3020T3	E	N	()
35W MR11 (integral transformer)	TL3035MT11	E	N	()
27W 1156*	TL3027LV	E	N	()

Note: Lamp not included except Type 1156, included.
 *Low voltage transformer required.

Model No.	Shroud	Distribution	Finish
	E	N	

Dimensions

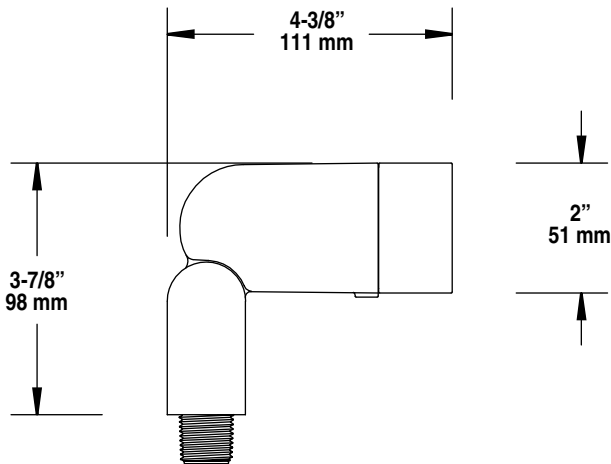

Project Notes:

Approval:

Any dimension on this sheet is to be assumed a reference dimension and used for information purposes only. It does not govern manufacturing or inspection requirements.

Bronzelite®
 100 Craftway Drive • Littlestown, PA 17340
 800 273-1569 • Fax 717 359-9545 www.bronzelite.com

Some luminaires use fluorescent or high intensity discharge (HID) lamps that contain small amounts of mercury. Such lamps are labeled "Contains Mercury" and/or with the symbol "Hg." Lamps that contain mercury must be disposed of in accordance with local requirements. Information regarding lamp recycling and disposal can be found at www.lamprecycle.org